

Multi-split type

Air-Condition Your Whole Home with a Single Outdoor Unit

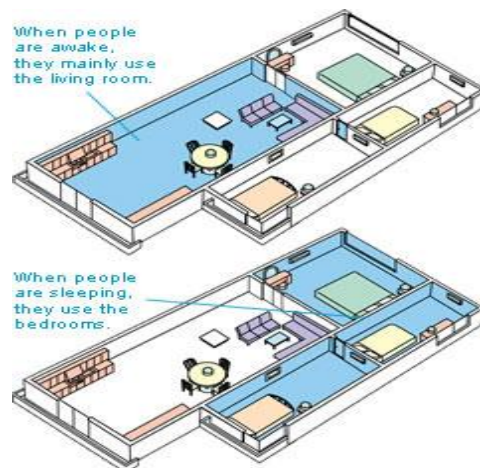

With a multi-split type air conditioner, a single outdoor unit can be connected to multiple indoor units, solving any problem of limited installation space.



Benefits of multi-split type air conditioners

The living room is used most when people are awake. When they are asleep, the bedrooms are used most. Based on these usage patterns, it is unusual for all indoor units to be operated simultaneously, so a multi-split type air conditioner is the right choice for the home.

With a split type unit, indoor and outdoor units are both required for each room. However, the multi-split type allows a single outdoor unit to be connected to multiple indoor units. As the outdoor unit's capacity is shared between operating indoor units as needed, a smaller-scale system can handle the whole home.

This solves the problems of limited installation space as well as exterior clutter.

Individual and centralized control

The optional 5-room centralized controller allows the operation of each unit to be set from one location. Family members can activate the unit in their rooms as required using the remote controller.